



BUILD the **HUB**

HUB

*“the effective center
of an activity, region,
or network.”*





As we look back over the life of our church, we have seen God shift, move, protect, and provide. With His track record in the past, we stand confident the future will be no different. Building a Hub now allows us to continue propelling Mount Pleasant and the surrounding areas into an authentic relationship with Jesus. We cannot wait to see the lives changed, addictions broken, marriages restored, leaders equipped, and more that will come through our obedience in this next season. We are honored to have the opportunity to do this journey with you!

Let's Build a Hub,
Pastor Nick & Tori Newman

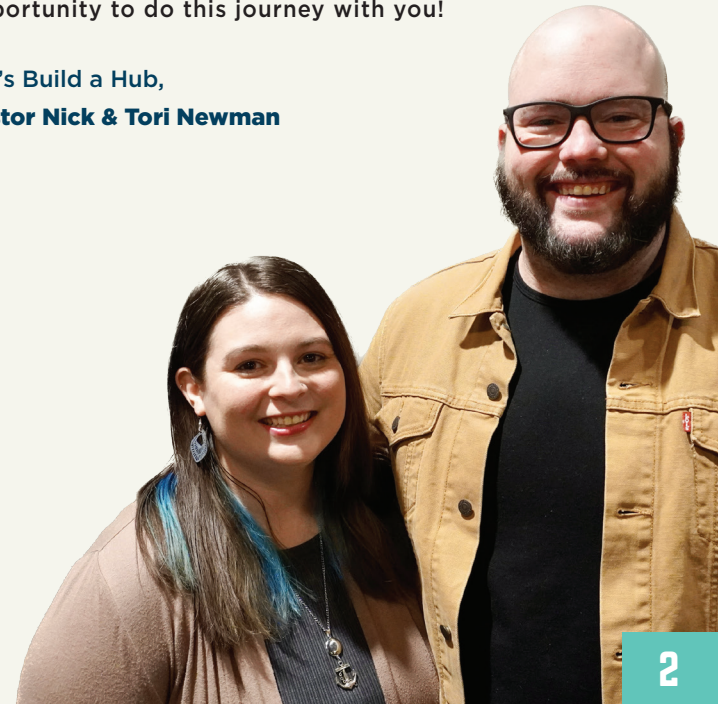

September 2015

Pastor Nick and Tori hosted the first Sunday gathering of Propel Church in Mount Pleasant High School.

September 2018

We made the jump to two Sunday worship experiences to create more space for people to meet Jesus.

December 2019

We transitioned from portable and started the build out of a permanent location in Mount Pleasant located at 400 N. Main Street.

March 2020

We began meeting weekly online and filmed our experiences at 400 N. Main Street during the pandemic.

December 2020

After many months of being online we were able to regather as a church to host in-person worship experiences.

September 2022

We closed on 6.88 acres of land in cash for \$325,000 and made MPMS our temporary home.

November 2022

An additional 1.18 acres of land was donated to bring our acreage total to 8.06.



Our history shows God's faithfulness

STORIES OF LIFE CHANGE

“In the spring of 2019, we were asked to relocate for Darin’s job. After time spent in prayer and discussion with family and our church community in Pennsylvania, we decided to make the move to Concord. After we closed on our home, we set to work finding a new church home. After making a list of churches on the ARC website, Propel was our first church visit. We immediately saw a church of genuine people with Bible-based teaching, where our kids were cared for. After attending Discover and finding our fit with our unique giftings, we’ve both plugged in with hearts eager to serve. At Propel, we’ve not only found community, but also people that we are able to do life with!”



The Zook Family

JIMMY'S STORY



“When I found Propel, I was about a decade into a drug addiction. I had done the church thing in the past, but I never could find where I felt I belonged. I decided to join the Freedom small group where I was not only able to break the chains of addiction, but also build relationships with a group of guys that held me accountable. Four years later, they are still some of my best friends today. Not only have I found my home at Propel, I’ve been able to discover my purpose and actually make a difference in people’s lives.”

“Five years ago I attended Propel for the first time with some of my family and we felt welcomed from the beginning. I attended Discover and found my place serving in Propel Kids. My husband Mike didn’t come to church often because of work, but during COVID he made a job change and would have Sundays off. For a while on Sundays he would go play golf, but I really wanted him at church with his family. I prayed each Sunday for him to come with me. Finally I said, “God, I’m giving this to You.” A few weeks later we had some inclement weather, and he came to church. For the next three weeks, we continued to have poor weather, so he came to church with us. A few months later he made the decision to go to Discover and asked if I would join him. Mike found his place to serve, took his next step with baptism, and has continued to grow ever since.”

MIKE & LISA'S STORY



BUILDING THE HUB

- PROPEL KIDS
- FOOD PREP/ FOOD SERVICE
- LOBBY/GATHERING/PUBLIC CIRCULATION
- OFFICE/ADMIN
- RESTROOM/UTILITY
- WORSHIP/AUDITORIUM

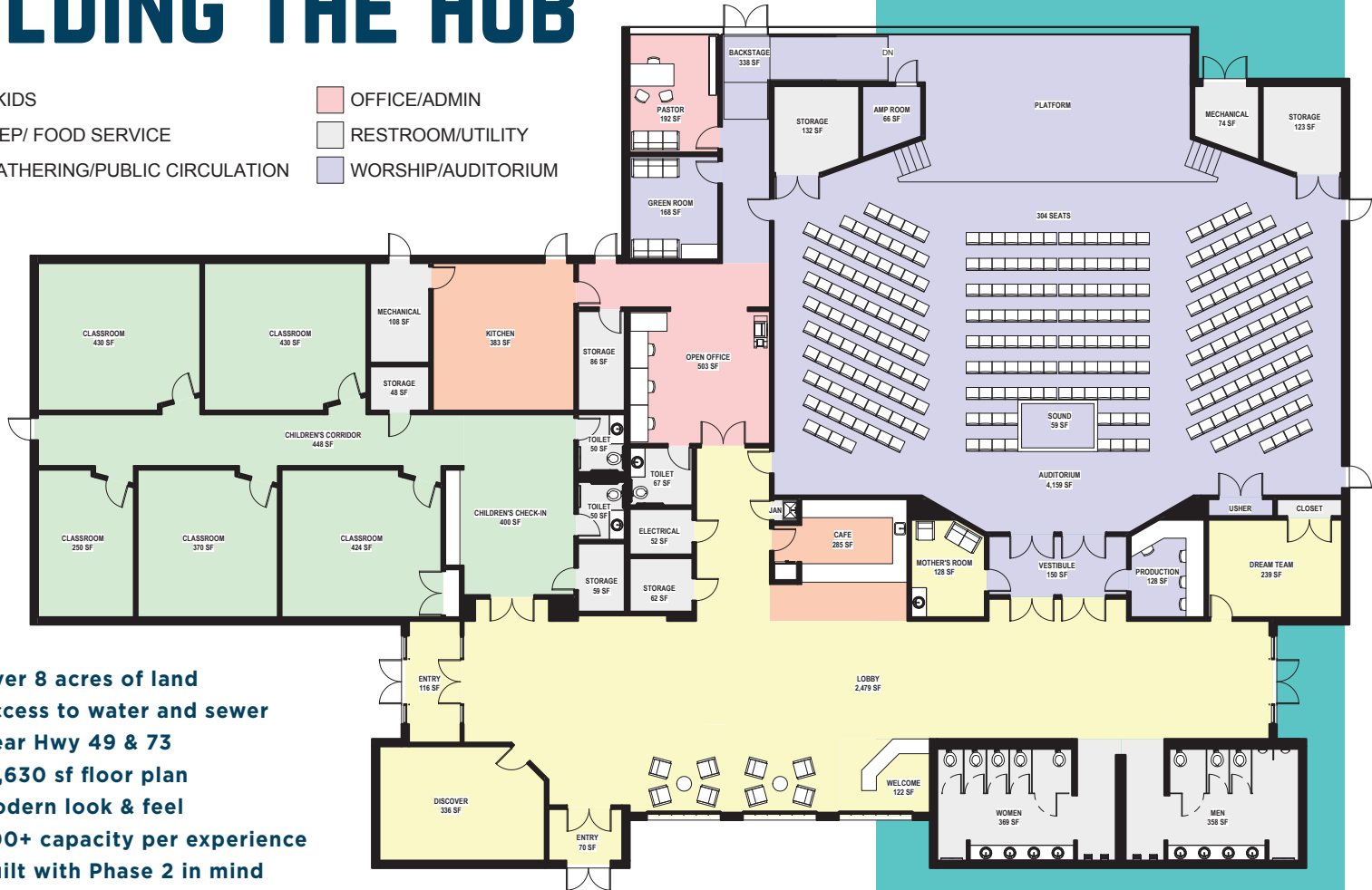

- + Over 8 acres of land
- + Access to water and sewer
- + Near Hwy 49 & 73
- + 15,630 sf floor plan
- + Modern look & feel
- + 500+ capacity per experience
- + Built with Phase 2 in mind

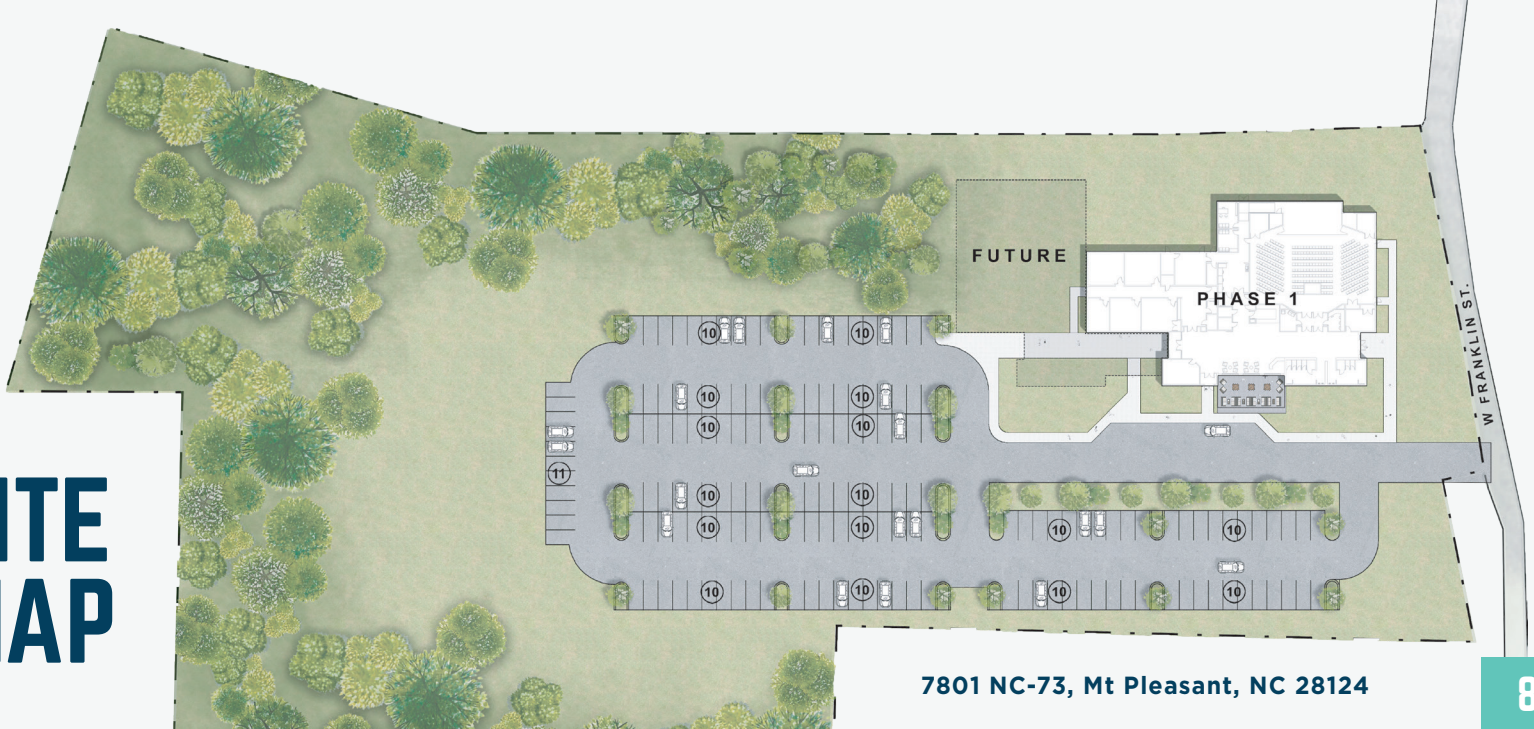

SITE MAP

7801 NC-73, Mt Pleasant, NC 28124



SPACE TO GATHER & GROW

Our facility will feature a multi-purpose gathering space for Sunday worship experiences, leadership trainings, events, and more. This flexibility allows us to best serve the community of Mount Pleasant, the people who call Propel home, and other churches.



- + AUDITORIUM WITH CAPACITY FOR 325+
- + FLAT AUDITORIUM FOR MULTI-PURPOSE USE

- + MULTIPLE ACCESS POINTS FOR ENTRY AND EXIT
- + EXPANDED BROADCAST AND MEDIA CAPABILITIES

- + 2,749 SF LOBBY SPACE WITH CAFE
- + INVITING GATHERING PLACE BEFORE AND AFTER EXPERIENCES
- + EXTERIOR LOUNGE/CAFE SEATING

- + FLEX SPACE FOR DISCOVER/SMALL GROUPS
- + OPEN OUTDOOR GREEN SPACE WITH ABILITY TO HOST FOOD TRUCKS AND OTHER COMMUNITY-WIDE OUTREACH EVENTS



SPACE FOR COMMUNITY



Our vision is to build more than just a functional church facility. We are building a hub for lost people to be saved, saved people to be empowered, and empowered people to be deployed back into the world to carry the hope of Jesus Christ.



SPACE FOR FUTURE GENERATIONS

One of the most important pursuits of a church is to reach the upcoming generations of kids and students. Our new facility will allow for kids and teens to learn about Jesus on their level and experience life change through Him.



- + 2,959 SF KIDS SPACE
- + EASILY ACCESSIBLE CHECK-IN POINT
- + SECURE HALLWAY, RESTROOM, AND CLASSROOM DESIGN

- + SPECIFIC, AGE-APPROPRIATE AREAS FOR LEARNING
- + MULTIPURPOSE FACILITY FOR STUDENT MINISTRY AND EVENTS
- + EXPANSION READY AS WE CONTINUE TO GROW

TOTAL PROJECT BUDGET
\$3,000,000

\$1,500,000 RAISED BY APRIL 2025

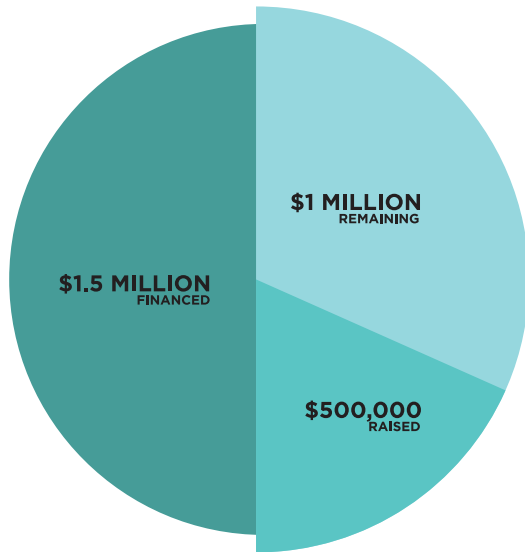

**WE ARE STARTING
OUR CAMPAIGN OFF
STRONG THANKS TO
THE GENEROSITY OF
OUR CHURCH**

33%
ALREADY RAISED

TIMELINE

1 PHASE ONE

PROPERTY & DESIGN



COMPLETE
EARLY 2023



IN PROGRESS

- + Acquire 8 acres of land near 49 & 73
- + Architectural design of new facility
- + Civil engineering design of site plan

2 PHASE TWO

SITE WORK & CONSTRUCTION



COMPLETE
SPRING 2024



10-14 MONTHS

- + Break ground & begin sitework
- + Construct auditorium, lobby, & kids structure
- + Equipment with utilities & permanent fixtures

3 PHASE THREE

INTERIOR FURNISHINGS & EQUIPMENT



COMPLETE
FALL 2024



3-4 MONTHS

- + Install audio, video, & lighting
- + Furnish kids, lobby, & auditorium
- + Move in non-fixed equipment

IS IT EVEN POSSIBLE?

“JESUS LOOKED AT THEM INTENTLY AND SAID, ‘HUMANLY SPEAKING, IT IS IMPOSSIBLE. BUT WITH GOD EVERYTHING IS POSSIBLE.’”

MATTHEW 19:26

24 MONTHS OF ABOVE & BEYOND GENEROSITY

BUILD THE HUB IS A CHURCH-WIDE FINANCIAL FUNDING INITIATIVE THAT IS A 24-MONTH COMMITMENT TO RAISE \$1,000,000 TOWARD OUR NEW PERMANENT FACILITY

WHAT
RAISING
\$1,000,000
LOOKS
LIKE

\$500,000
ALREADY
RAISED

1 COMMITMENT
OF \$100,000
= \$100,000

4 COMMITMENTS
OF \$50,000
= \$200,000

10 COMMITMENTS
OF \$25,000
= \$250,000

20 COMMITMENTS
OF \$7,500
= \$150,000

BECOME A HUB BUILDER



25 COMMITMENTS
OF \$5,000
= \$125,000

40 COMMITMENTS
OF \$2,500
= \$100,000

75 COMMITMENTS
OF \$1,000
= \$75,000

TOGETHER WE CAN RAISE
\$1,500,000

BIG GIVE
GIFT

MONTHLY
COMMITMENT

2 YEAR
GIVING TOTAL

\$5,000

\$833

\$25,000

\$2,000

\$333

\$10,000

\$500

\$187

\$5,000

\$100

\$100

\$2,500

BIG GIVE GIFT:

Raising \$1,500,000 over the next two years will allow us to meet the minimum lending requirement needed to start our building project. Therefore, your generous BIG GIVE gifts will lay the foundation for our Build The Hub initiative and cover most of our efforts to break ground.

CREATIVE WAYS TO GIVE

There are many ways to participate in giving.
Here are a few to consider:

APPRECIATED ASSETS

Consider transferring appreciated assets like stocks, real estate, etc as a way to increase giving and fulfill your commitment.

SALE OF ASSETS

Donate money from the sale of personal or business assets.

SAVINGS & INVESTMENTS

You may be able to give some portion of your accumulated assets without significantly affecting your financial future security.

DELAYED EXPENDITURES

Choose to delay an anticipated purchase.

INCOME-PRODUCING ASSETS

Consider giving interest earned, income from rental properties, or funds from other income-producing assets.

INCOME & SACRIFICE

Consider pledging 10% of your annual income in addition to your regular financial support of Propel Church.

TOGETHER WE CAN

“REMEMBER THIS—A FARMER WHO PLANTS ONLY A FEW SEEDS WILL GET A SMALL CROP. BUT THE ONE WHO PLANTS GENEROUSLY WILL GET A GENEROUS CROP. YOU MUST EACH DECIDE IN YOUR HEART HOW MUCH TO GIVE. AND DON’T GIVE RELUCTANTLY OR IN RESPONSE TO PRESSURE. ‘FOR GOD LOVES A PERSON WHO GIVES CHEERFULLY.’ AND GOD WILL GENEROUSLY PROVIDE ALL YOU NEED. THEN YOU WILL ALWAYS HAVE EVERYTHING YOU NEED AND PLENTY LEFT OVER TO SHARE WITH OTHERS.”

2 CORINTHIANS 9:6-8

HOW WILL I KNOW HOW MUCH TO GIVE?

This is between you and the Lord. We never ask you to give a certain amount. You should give whatever He puts in your heart to give. Follow this path and let God be your guide.

1
PRAY

Ask God how He wants you to give as an individual or family.

2
LISTEN

Remain open to how He wants you to contribute to the growth of His Kingdom.

3
OBEY

Take a brave step of faith and follow through on His instructions to you.

4
WATCH

Prepare to see how God works through us for His will to be done.

GIVING PROCESS

- + Review the campaign information materials prayerfully.
- + Make a decision and commit to it. Determine in your heart to see your commitment through.
- + Fill out a Build the Hub commitment envelope in-person. Plan to turn it in, along with your initial BIG GIVE gift, on Sunday, March 19th.
- + We encourage you to set up a recurring donation for your Build The Hub commitment over the duration of the next 24 months.
- + Everyone who gives will receive a regular update on the project with financials, progress, and news.
- + You will not receive giving reminders, but you will receive letters of appreciation to celebrate milestones along the journey.



FAQ

What is the business plan for funding our new facility? We plan to utilize cash on hand, income from our funding initiative, and long term borrowing. When we reach our giving goal, upon completion of the building, Propel Church will have instant equity in the facility, making it an asset to the ministry.

Should I redirect my regular giving to Build the Hub? Giving to "Build The Hub" is a sacrificial gift above and beyond your regular giving. This additional support enables a growth initiative outside of Propel Church's regular operating budget. Regular giving goes to support the operating budget, which funds day-to-day ministry.

Is my giving tax-deductible? Yes, all donations to Propel Church are 100% tax-deductible.

What happens if I am unable to fulfill my commitment? Nothing. Who you are is way more important to us than what you do for the church. We want everyone to feel welcomed and valuable. Our greatest resource isn't financial, but rather the faithful family that God has brought to this church.

WAYS TO GIVE

GIVE ONLINE



ONLINE GIVING IS EASY, SAFE, AND SECURE. YOU CAN AUTOMATE AND SCHEDULE YOUR GIFTS, SAVE YOUR BANK OR CARD INFO, AND EASILY TRACK AND ADJUST YOUR GIVING.

TEXT TO GIVE



GIVING TO PROPEL IS AS EASY AS A TEXT MESSAGE. SIMPLY TEXT AN AMOUNT AND #HUB (EXAMPLE: 50 #HUB) TO 704-228-4123

GIVE IN-PERSON OR BY MAIL



IN ADDITION TO DIGITAL GIVING, WE ALSO ACCEPT CASH, CHECKS, AND MONEY ORDERS. THESE CAN BE PLACED IN THE GIVING BUCKETS AT OUR WORSHIP EXPERIENCES OR MAILED TO:

PROPEL CHURCH • PO BOX 1288, MOUNT PLEASANT, NC 28124

Learn more at www.propel.church/buildthehub

propel
church



www.propel.church/buildthehub